

Model: B1.5-9.1Y

Refrigerant: R404A

Power supply: 400/3/50 DOL-STAR

Technical data:

Displacement	8.96 m³/h
Nominal compressor speed	1450 rpm
Motor voltage	400 V
Nominal operating frequency	50 Hz
maximum allowed operating current (MRA)	5.9 A
locked rotor current (LRA)	26.8 A
Number of pistons	2
Net weight	38 kg
Lubricant	FRASCOLD POE32
Oil charge	1 l

Motor connections:

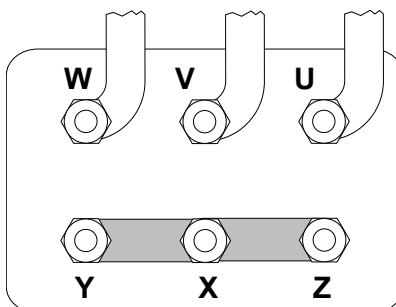

Application range:

Additional cooling required

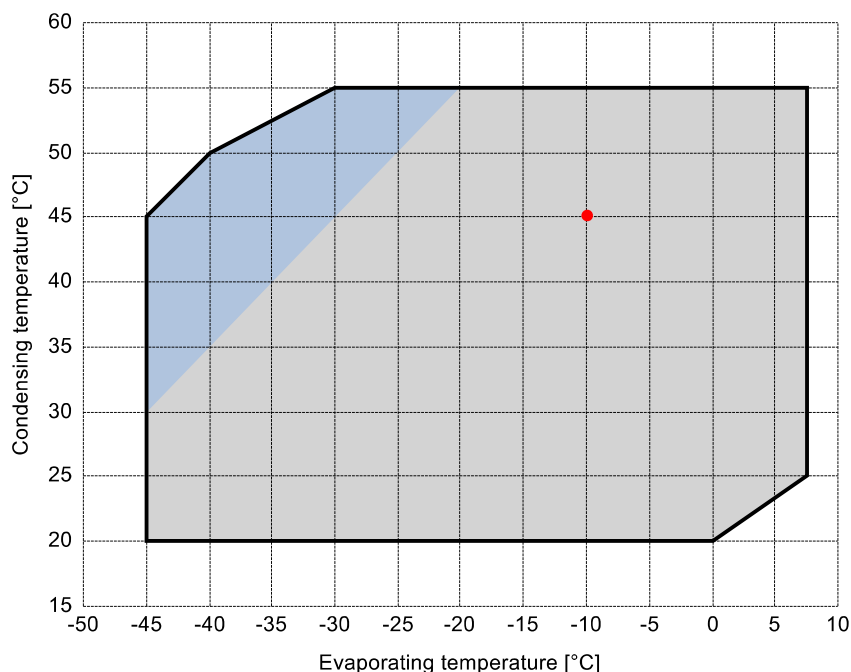

Reference conditions according to EN12900

- Suction gas temperature = 20 °C
- Liquid subcooling = 0 K
- 100% of the capacity

Certified by:

- ASERCOM (ref. EN12900, 50 Hz, 100% cap.)

All data subject to change without notice

Model: B1.5-9.1Y

Refrigerant: R404A

Power supply: 400/3/50 DOL-STAR

Dimensions:

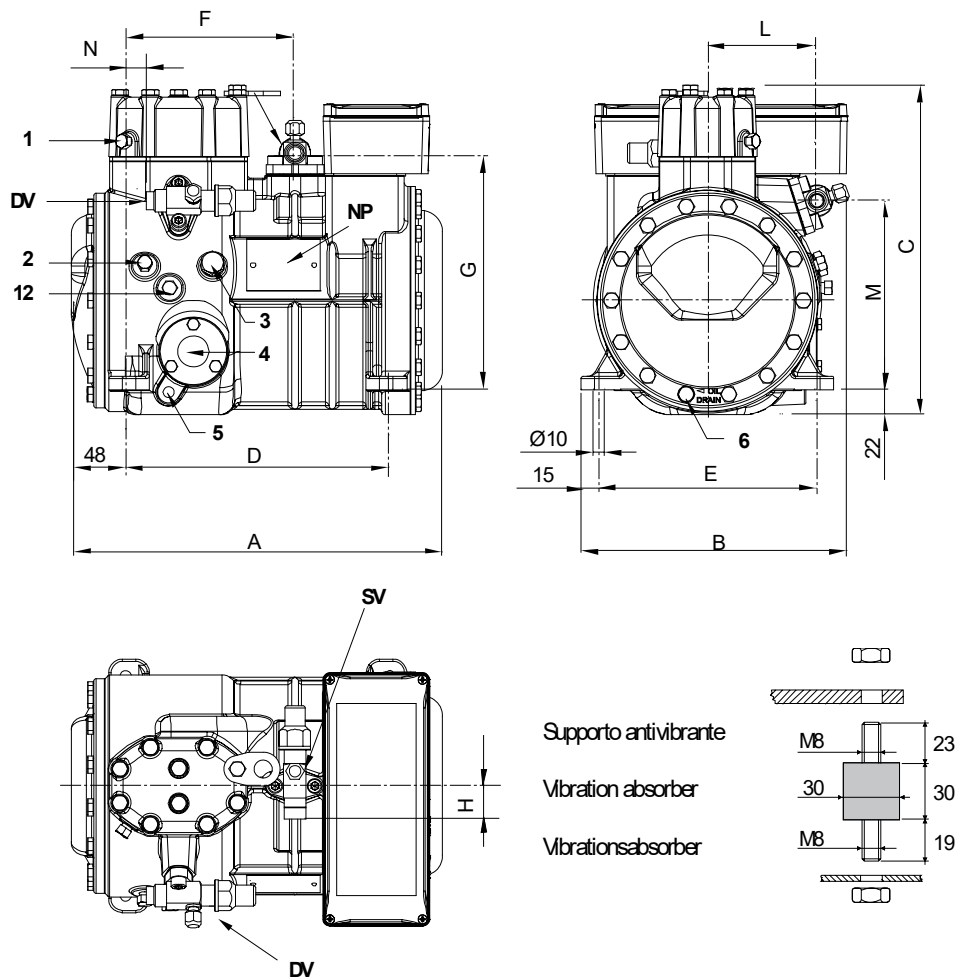

Legend:

SV: Suction Valve	5/8" in - 16 mm	M: Discharge valve	167 mm
DV: Discharge valve	1/2" in - 12.7 mm	N: Discharge valve	18 mm
A: Length	329 mm	1: High pressure connection	1/8" NPT
B: Width	237 mm	2: Low pressure connection	1/8" NPT
C: Height	292 mm	3: Oil charge plug	1/4" GAS
D: Base mounting	234 mm	4: Oil level sight glass	-
E: Base mounting	194 mm	5: Crankcase heater seat	-
F: Suction Valve	150 mm	6: Oil drain plug	M8 x 22
G: Suction Valve	209 mm	12: Oil return plug	1/8" NPT
H: Suction Valve	29 mm	NP: Nameplate	
I: Discharge valve	97 mm		

All data subject to change without notice

Model: B1.5-9.1Y

Refrigerant: R404A

Power supply: 400/3/50 DOL-STAR

P&I Diagram:

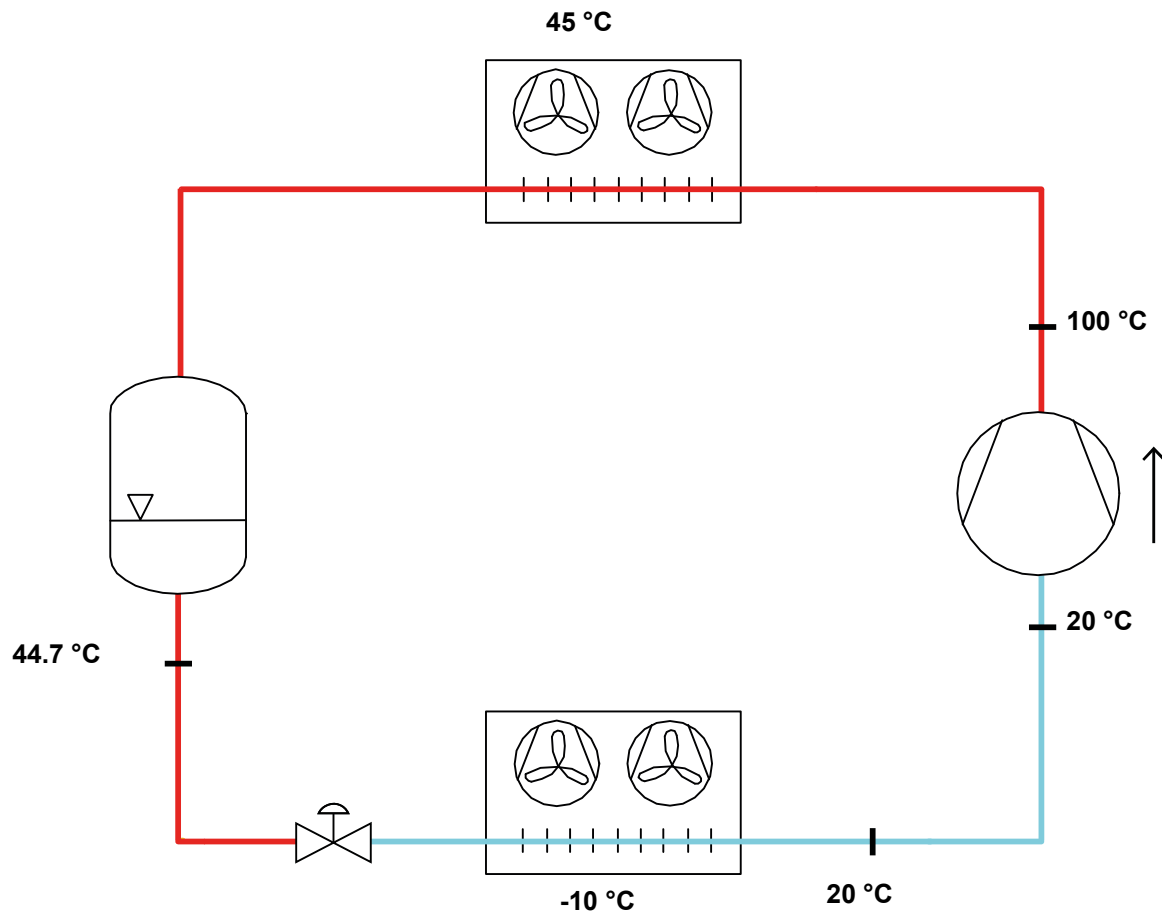

Model: B1.5-9.1Y

Refrigerant: R404A

Power supply: 400/3/50 DOL-STAR

Performance data:

Operating mode	Subcritical, 100 % of the capacity
Liquid subcooling	0 K
Suction gas temperature	20 °C
Useful fraction of superheating	100 %
Frequency	50 Hz
Additional cooling required	

Refrigerating capacity [kW]

T.Evap	-40 °C	-35 °C	-30 °C	-25 °C	-20 °C	-15 °C	-10 °C	-5 °C	0 °C	5 °C	7.5 °C
T.Cond											
55 °C	-	-	1.209	1.57	2.021	2.577	3.251	4.06	5.019	6.142	6.771
50 °C	0.79	1.057	1.392	1.81	2.326	2.955	3.713	4.614	5.674	6.908	7.594
45 °C	0.893	1.197	1.577	2.049	2.629	3.33	4.169	5.16	6.319	7.661	8.405
40 °C	1	1.338	1.762	2.286	2.927	3.699	4.617	5.697	6.953	8.401	9.202
35 °C	1.109	1.479	1.944	2.519	3.22	4.06	5.056	6.222	7.574	9.127	9.983
30 °C	1.217	1.618	2.123	2.747	3.505	4.412	5.483	6.734	8.18	9.835	10.746
25 °C	1.323	1.753	2.296	2.966	3.78	4.752	5.897	7.231	8.769	10.525	11.489
20 °C	1.425	1.882	2.461	3.177	4.045	5.08	6.297	7.712	9.339	-	-

Power input [W]

T.Evap	-40 °C	-35 °C	-30 °C	-25 °C	-20 °C	-15 °C	-10 °C	-5 °C	0 °C	5 °C	7.5 °C
T.Cond											
55 °C	-	-	1435	1636	1856	2090	2332	2579	2824	3063	3178
50 °C	1100	1248	1420	1612	1819	2036	2258	2480	2697	2903	3002
45 °C	1087	1232	1398	1579	1772	1970	2170	2366	2553	2726	2806
40 °C	1070	1210	1368	1537	1714	1892	2068	2237	2392	2530	2591
35 °C	1049	1183	1331	1486	1645	1803	1953	2093	2215	2316	2357
30 °C	1024	1150	1287	1427	1567	1701	1825	1934	2022	2085	2105
25 °C	995	1113	1236	1360	1479	1589	1684	1761	1813	1836	1835
20 °C	963	1070	1178	1284	1381	1465	1530	1573	1588	-	-

COP/EER [W/W]

T.Evap	-40 °C	-35 °C	-30 °C	-25 °C	-20 °C	-15 °C	-10 °C	-5 °C	0 °C	5 °C	7.5 °C
T.Cond											
55 °C	-	-	0.84	0.96	1.09	1.23	1.39	1.57	1.78	2.01	2.13
50 °C	0.72	0.85	0.98	1.12	1.28	1.45	1.64	1.86	2.1	2.38	2.53
45 °C	0.82	0.97	1.13	1.3	1.48	1.69	1.92	2.18	2.48	2.81	3
40 °C	0.93	1.11	1.29	1.49	1.71	1.95	2.23	2.55	2.91	3.32	3.55
35 °C	1.06	1.25	1.46	1.7	1.96	2.25	2.59	2.97	3.42	3.94	4.23
30 °C	1.19	1.41	1.65	1.92	2.24	2.59	3	3.48	4.05	4.72	5.1
25 °C	1.33	1.58	1.86	2.18	2.56	2.99	3.5	4.11	4.84	5.73	6.26
20 °C	1.48	1.76	2.09	2.47	2.93	3.47	4.11	4.9	5.88	-	-

Current [A]

T.Evap	-40 °C	-35 °C	-30 °C	-25 °C	-20 °C	-15 °C	-10 °C	-5 °C	0 °C	5 °C	7.5 °C
T.Cond											
55 °C	-	-	3.59	3.78	4.02	4.28	4.55	4.81	5.09	5.4	5.59
50 °C	3.35	3.44	3.58	3.76	3.98	4.22	4.46	4.71	4.94	5.18	5.31
45 °C	3.34	3.43	3.56	3.73	3.92	4.14	4.37	4.58	4.78	4.97	5.06
40 °C	3.33	3.41	3.53	3.68	3.86	4.06	4.25	4.44	4.61	4.76	4.83
35 °C	3.32	3.4	3.5	3.64	3.79	3.96	4.13	4.28	4.42	4.53	4.57
30 °C	3.3	3.38	3.47	3.58	3.71	3.85	3.98	4.1	4.2	4.27	4.3
25 °C	3.29	3.35	3.43	3.53	3.63	3.73	3.83	3.91	3.97	3.99	3.99
20 °C	3.28	3.33	3.39	3.47	3.54	3.62	3.68	3.72	3.73	-	-

All data subject to change without notice

Model: B1.5-9.1Y

Refrigerant: R404A

Power supply: 400/3/50 DOL-STAR

Performance data:

Operating mode	Subcritical, 100 % of the capacity
Liquid subcooling	0 K
Suction gas temperature	20 °C
Useful fraction of superheating	100 %
Frequency	50 Hz
Additional cooling required	

Mass flow [kg/h]

T.Evap	-40 °C	-35 °C	-30 °C	-25 °C	-20 °C	-15 °C	-10 °C	-5 °C	0 °C	5 °C	7.5 °C
T.Cond											
55 °C	-	-	41	54	70	90	115	146	183	229	255
50 °C	24	33	44	57	74	95	120	151	189	234	260
45 °C	26	35	46	60	77	99	125	157	194	240	266
40 °C	27	36	48	62	81	103	129	161	199	245	271
35 °C	28	38	50	65	83	106	133	165	204	249	275
30 °C	29	39	51	67	86	109	136	169	208	254	279
25 °C	30	40	53	69	88	111	139	172	211	257	283
20 °C	31	41	54	70	90	113	142	175	214	-	-