

## Model: B2-10.1Y

Refrigerant: R404A

Power supply: 400/3/50 DOL-STAR

### Technical data:

Displacement	9.88 m³/h
Nominal compressor speed	1450 rpm
Motor voltage	400 V
Nominal operating frequency	50 Hz
maximum allowed operating current (MRA)	6.7 A
locked rotor current (LRA)	35.9 A
Number of pistons	2
Net weight	40 kg
Lubricant	FRASCOLD POE32
Oil charge	1 l

### Motor connections:

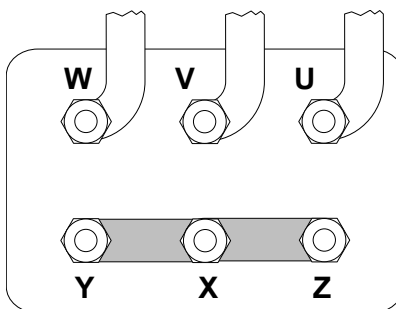

### Application range:

Additional cooling required

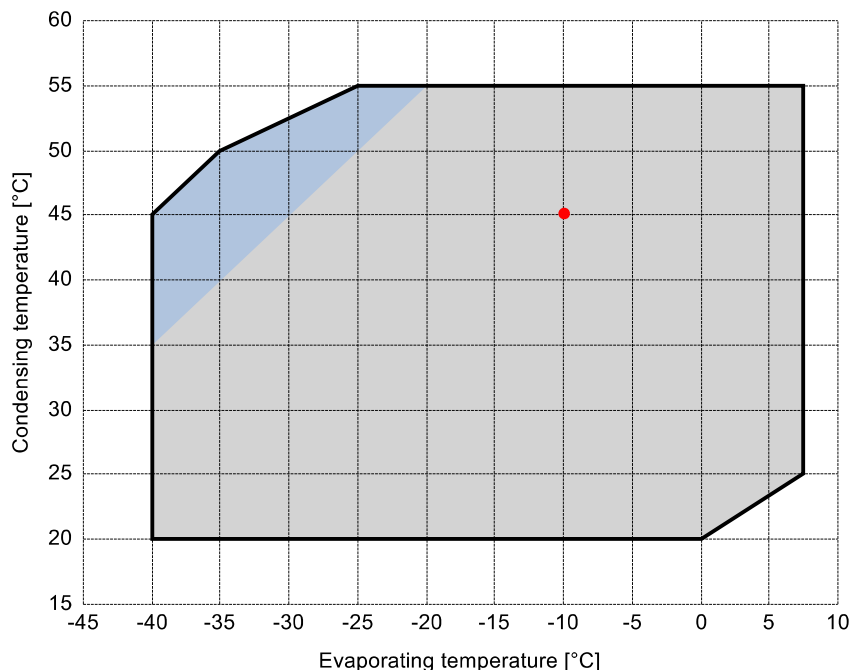

#### Reference conditions according to EN12900

- Suction gas temperature = 20 °C
- Liquid subcooling = 0 K
- 100% of the capacity

#### Certified by:

- ASERCOM (ref. EN12900, 50 Hz, 100% cap.)

All data subject to change without notice

## Model: B2-10.1Y

Refrigerant: R404A

Power supply: 400/3/50 DOL-STAR

## Dimensions:

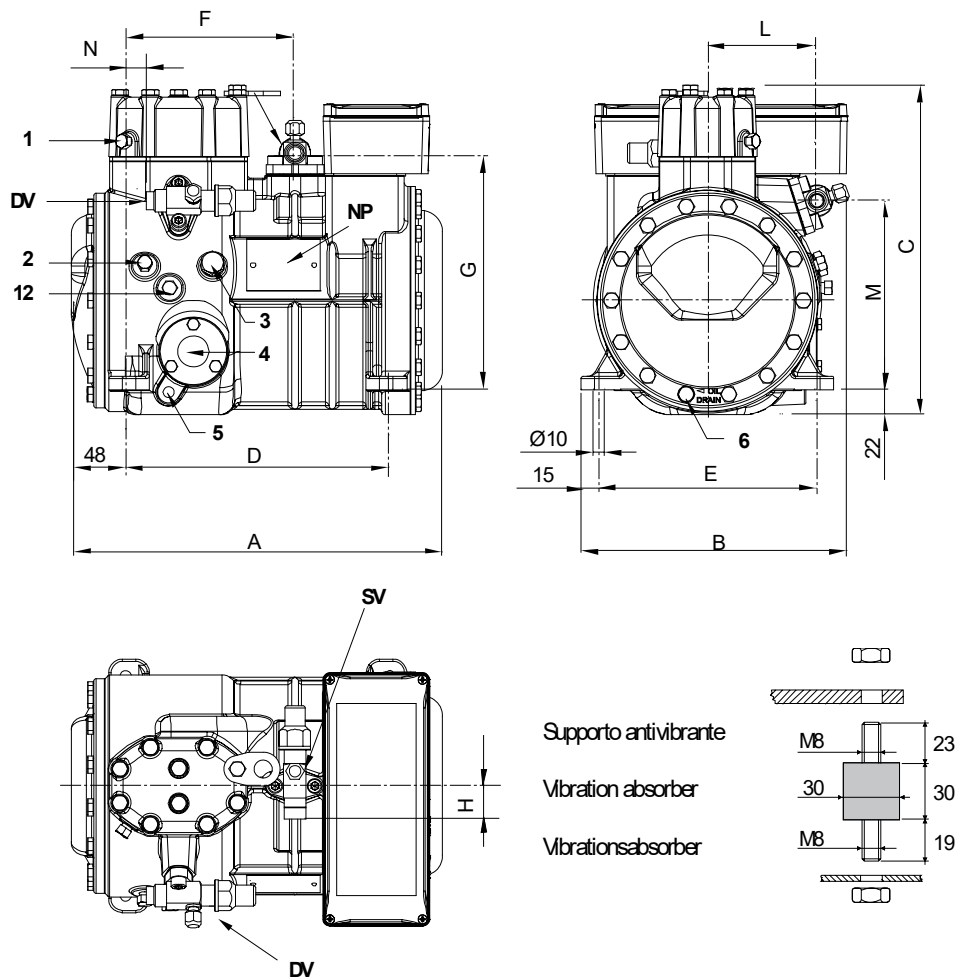

## Legend:

SV: Suction Valve	3/4" in - 19 mm	M: Discharge valve	167 mm
DV: Discharge valve	5/8" in - 16 mm	N: Discharge valve	18 mm
A: Length	334 mm	1: High pressure connection	1/8" NPT
B: Width	237 mm	2: Low pressure connection	1/8" NPT
C: Height	292 mm	3: Oil charge plug	1/4" GAS
D: Base mounting	234 mm	4: Oil level sight glass	-
E: Base mounting	194 mm	5: Crankcase heater seat	-
F: Suction Valve	150 mm	6: Oil drain plug	M8 x 22
G: Suction Valve	209 mm	12: Oil return plug	1/8" NPT
H: Suction Valve	31 mm	NP: Nameplate	
L: Discharge valve	97 mm		

All data subject to change without notice

**Model: B2-10.1Y**

Refrigerant: R404A

Power supply: 400/3/50 DOL-STAR

## P&I Diagram:

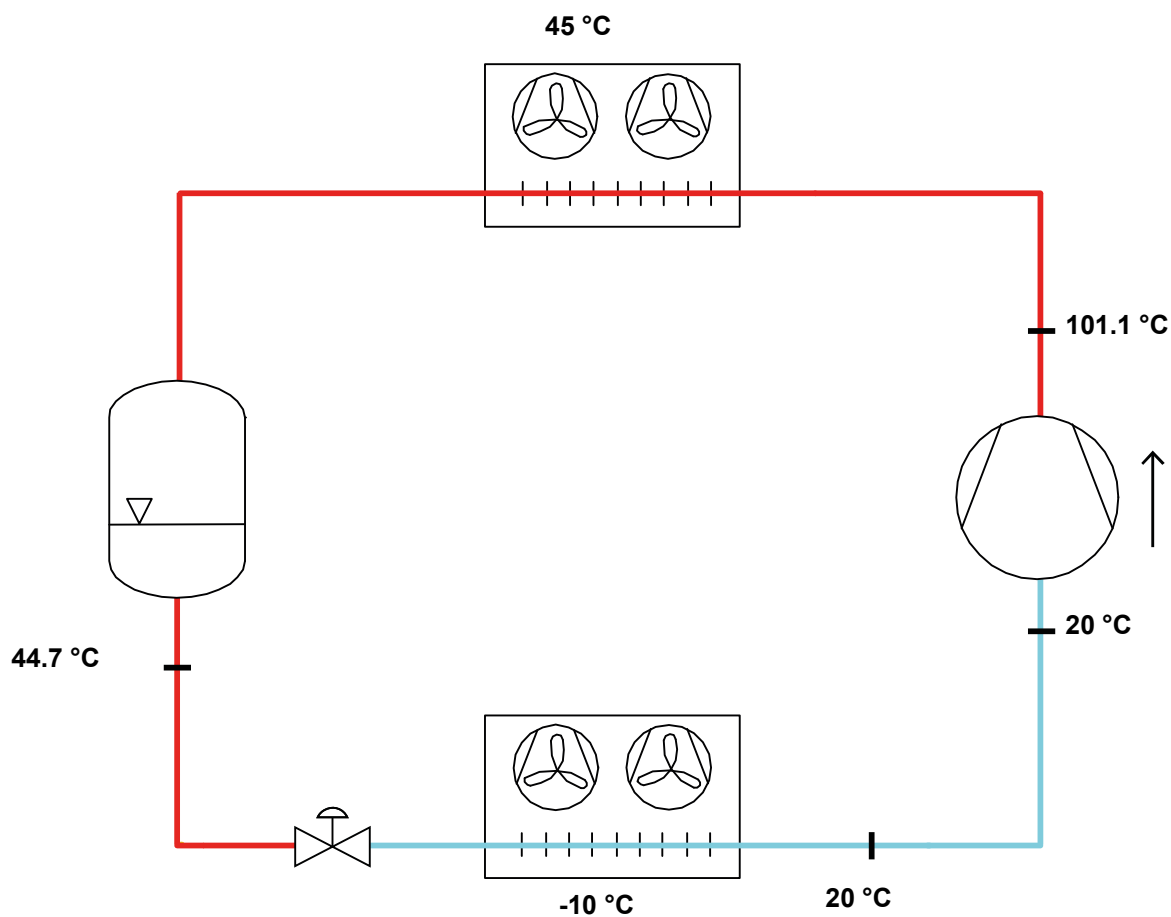

**Model: B2-10.1Y**

Refrigerant: R404A

Power supply: 400/3/50 DOL-STAR

**Performance data:**

Operating mode	Subcritical, 100 % of the capacity
Liquid subcooling	0 K
Suction gas temperature	20 °C
Useful fraction of superheating	100 %
Frequency	50 Hz
Additional cooling required	

**Refrigerating capacity [kW]**

T.Evap	-40 °C	-35 °C	-30 °C	-25 °C	-20 °C	-15 °C	-10 °C	-5 °C	0 °C	5 °C	7.5 °C
T.Cond											
55 °C	-	-	-	1.896	2.415	3.029	3.754	4.603	5.589	6.727	7.357
50 °C	-	1.213	1.623	2.113	2.698	3.389	4.202	5.151	6.248	7.508	8.203
45 °C	0.963	1.34	1.794	2.339	2.99	3.759	4.661	5.709	6.918	8.301	9.062
40 °C	1.066	1.476	1.974	2.575	3.292	4.14	5.131	6.28	7.601	9.107	9.933
35 °C	1.178	1.621	2.165	2.822	3.606	4.533	5.614	6.864	8.297	9.927	10.82
30 °C	1.301	1.778	2.367	3.081	3.933	4.939	6.111	7.463	9.009	10.763	11.722
25 °C	1.436	1.948	2.582	3.353	4.275	5.36	6.623	8.077	9.736	11.615	12.641
20 °C	1.583	2.131	2.812	3.641	4.631	5.796	7.151	8.708	10.482	-	-

**Power input [W]**

T.Evap	-40 °C	-35 °C	-30 °C	-25 °C	-20 °C	-15 °C	-10 °C	-5 °C	0 °C	5 °C	7.5 °C
T.Cond											
55 °C	-	-	-	1934	2175	2424	2675	2920	3151	3362	3457
50 °C	-	1469	1667	1884	2113	2346	2576	2795	2996	3171	3247
45 °C	1263	1435	1629	1837	2052	2267	2474	2666	2834	2972	3028
40 °C	1235	1405	1593	1791	1991	2186	2368	2530	2664	2763	2797
35 °C	1212	1379	1559	1744	1927	2100	2255	2386	2484	2542	2554
30 °C	1192	1354	1525	1695	1859	2008	2134	2232	2292	2307	2296
25 °C	1173	1329	1488	1642	1784	1907	2004	2066	2086	2057	2022
20 °C	1154	1301	1446	1582	1702	1797	1861	1886	1865	-	-

**COP/EER [W/W]**

T.Evap	-40 °C	-35 °C	-30 °C	-25 °C	-20 °C	-15 °C	-10 °C	-5 °C	0 °C	5 °C	7.5 °C
T.Cond											
55 °C	-	-	-	0.98	1.11	1.25	1.4	1.58	1.77	2	2.13
50 °C	-	0.83	0.97	1.12	1.28	1.44	1.63	1.84	2.09	2.37	2.53
45 °C	0.76	0.93	1.1	1.27	1.46	1.66	1.88	2.14	2.44	2.79	2.99
40 °C	0.86	1.05	1.24	1.44	1.65	1.89	2.17	2.48	2.85	3.3	3.55
35 °C	0.97	1.18	1.39	1.62	1.87	2.16	2.49	2.88	3.34	3.9	4.24
30 °C	1.09	1.31	1.55	1.82	2.12	2.46	2.86	3.34	3.93	4.66	5.1
25 °C	1.22	1.47	1.74	2.04	2.4	2.81	3.31	3.91	4.67	5.65	6.25
20 °C	1.37	1.64	1.94	2.3	2.72	3.22	3.84	4.62	5.62	-	-

**Current [A]**

T.Evap	-40 °C	-35 °C	-30 °C	-25 °C	-20 °C	-15 °C	-10 °C	-5 °C	0 °C	5 °C	7.5 °C
T.Cond											
55 °C	-	-	-	4.61	4.86	5.14	5.42	5.7	5.98	6.24	6.36
50 °C	-	4.15	4.34	4.56	4.8	5.05	5.31	5.56	5.79	6	6.1
45 °C	3.97	4.12	4.3	4.51	4.73	4.96	5.19	5.41	5.6	5.76	5.83
40 °C	3.94	4.09	4.26	4.46	4.67	4.88	5.08	5.26	5.41	5.52	5.56
35 °C	3.92	4.07	4.23	4.41	4.6	4.78	4.95	5.09	5.2	5.27	5.28
30 °C	3.91	4.04	4.2	4.36	4.53	4.69	4.82	4.93	4.99	5.01	5
25 °C	3.89	4.02	4.16	4.31	4.45	4.58	4.68	4.75	4.77	4.74	4.7
20 °C	3.88	4	4.13	4.25	4.37	4.47	4.53	4.56	4.54	-	-

All data subject to change without notice

**Model: B2-10.1Y**

Refrigerant: R404A

Power supply: 400/3/50 DOL-STAR

**Performance data:**

Operating mode	Subcritical, 100 % of the capacity
Liquid subcooling	0 K
Suction gas temperature	20 °C
Useful fraction of superheating	100 %
Frequency	50 Hz
Additional cooling required	

Mass flow [kg/h]	T.Evap	-40 °C	-35 °C	-30 °C	-25 °C	-20 °C	-15 °C	-10 °C	-5 °C	0 °C	5 °C	7.5 °C
T.Cond												
55 °C	-	-	-	65	84	106	133	165	204	251	277	
50 °C	-	38	51	67	86	109	136	169	208	255	281	
45 °C	28	39	52	68	88	112	140	173	213	260	286	
40 °C	29	40	54	70	91	115	144	178	218	265	292	
35 °C	30	41	55	73	93	118	148	183	223	271	298	
30 °C	31	43	57	75	96	122	152	187	229	277	305	
25 °C	33	45	59	78	99	126	156	193	235	284	311	
20 °C	35	47	62	80	103	129	161	198	240	-	-	