



Compressor
Voltage Code : FZ

AE4430Y-FZ1A

High Temp. Commercial (HP)

220 - 240V 1~ 50 Hz

R134a

AE4430Y-FZ1A_BR

Operating conditions : **Customized... / 50 Hz / Dew**

Sound Power
ISO3745 / ISO 3743-1

Evaporating Temp. : -10.0 °C
Superheat : 10.0 K
Return gas temp. : 10.0 °C
Condensing Temp. : 45.0 °C
Subcooling : 10.0 K
Liquid : 34.7 °C

Refrig. Capacity : 384 Watt

Power Input : 237 Watt
Amps : 1.85 A
C.O.P : 1.62 Watt/W

52 dBA

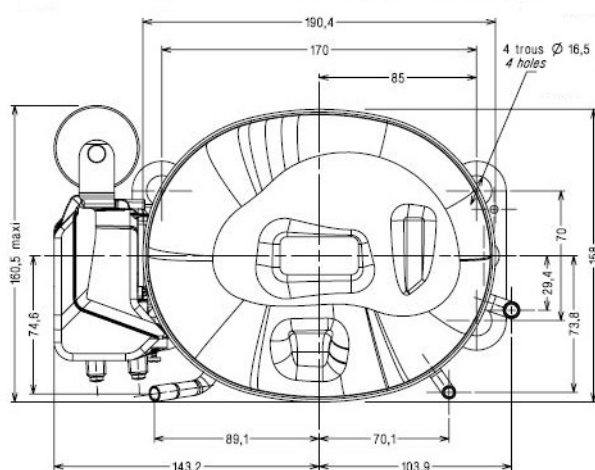
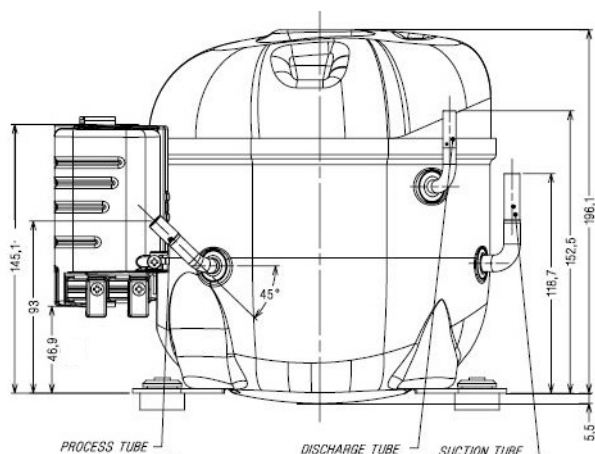

Displacement (cc) 8.0
Net Weight (Kg) 9.7
Oil Quantity (cc) 285.0
Oil Type Polyolester
Expansion Device Capillary_Tube/Expansion_Valve
Cooling Fan
Main Winding (Ohm) 8.5
Start Winding (Ohm) 53.4

Current
RLA (A) 2.1
LRA (A) 11.5

Electrical Equipment CSIR

Overload MST59AMK
Time Check 7.5s - 14s / 8.5 A
Open Temp 105° C
Close Temp 61° C

Start Capacitor 50 µF / 250 V

Current Relay MTRP0026
Pick Up 5.4A
Drop Out 4.55A

Refrigerating connection for OD
Suction Tube 6.35 (1/4")
Discharge Tube 4.76 (3/16")
Process Tube 6.35 (1/4")

Certificates :



Note : Tecumseh reserves the right to change information contained in this document without notification.

AE4430Y-FZ1A	Tension FZ : 220 - 240V 1~ 50 Hz
---------------------	---

Les performances sont données dans les conditions EN12900 :	Gaz aspirés : 20.0 °C
Condition Dew	Sous refroidissement : 0.0 K
The performance data are in EN12900 conditions :	Return gas : 20.0 °C
Dew Condition	Subcooling : 0.0 K

50 Hz R134a											
N°3042											
4 T condensation	5 T évaporation	(°C)	-25	-20	-15	-10	-5	0	5	10	15
30	1 P frigorifique	(Watt)	206	277	365	472	599	750	925	1129	1362
	2 P absorbée	(W)	169	184	199	212	224	233	240	243	242
	3 I absorbée	(A)	1.72	1.74	1.76	1.79	1.81	1.83	1.86	1.88	1.90
40	1 P frigorifique	(Watt)	175	239	318	412	526	659	816	998	1207
	2 P absorbée	(W)	175	193	211	230	248	264	278	290	299
	3 I absorbée	(A)	1.70	1.74	1.79	1.83	1.87	1.91	1.96	2.00	2.05
50	1 P frigorifique	(Watt)		201	270	352	450	566	702	861	1045
	2 P absorbée	(W)		199	222	244	267	290	312	332	350
	3 I absorbée	(A)		1.74	1.80	1.86	1.93	1.99	2.05	2.12	2.18
60	1 P frigorifique	(Watt)			223	292	374	471	586	722	879
	2 P absorbée	(W)			231	257	285	313	342	369	396
	3 I absorbée	(A)			1.81	1.89	1.97	2.06	2.14	2.23	2.31

--	--	--	--	--	--	--	--	--	--	--	--

1 = cooling capacity 2 = power input 3 = current 4 = condensing temperature 5 = evaporating temperature

<p>Nota : Tecumseh se réserve le droit de modifier les informations contenues dans ce document sans préavis.</p> <p>Note : Tecumseh reserves the right to change information contained in this document without notification.</p>
