



Compressor  
Voltage Code : FZ

AE4425Y-FZ1A

High Temp. Commercial (HP)

220 - 240V 1~ 50 Hz

R134a

AE4425Y-FZ1A\_BR

Operating conditions : **Customized... / 50 Hz / Dew**

**Sound Power**  
ISO3745 / ISO 3743-1

Evaporating Temp. : -10.0 °C  
Superheat : 10.0 K  
Return gas temp. : 10.0 °C  
Condensing Temp. : 45.0 °C  
Subcooling : 10.0 K  
Liquid : 34.7 °C

Refrig. Capacity : 293 Watt

Power Input : 192 Watt  
Amps : 1.35 A  
C.O.P : 1.53 Watt/W

50 dBA

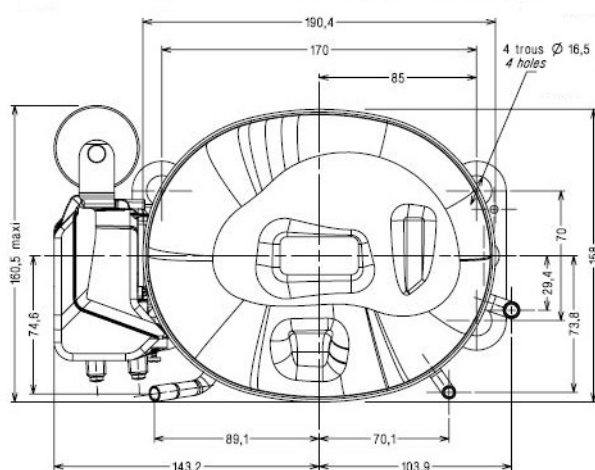
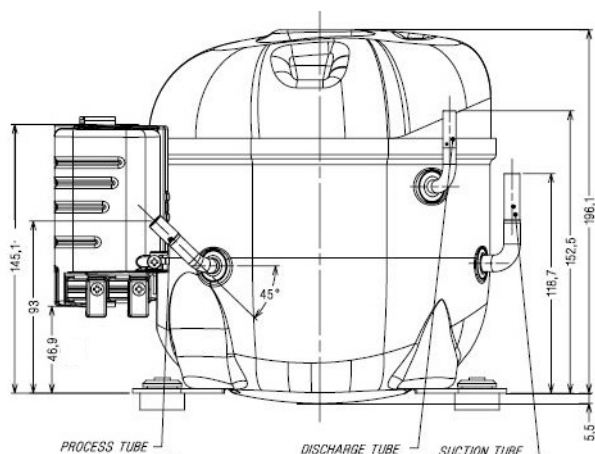

Displacement (cc) 6.69  
Net Weight (Kg) 9.1  
Oil Quantity (cc) 280.0  
Oil Type Polyolester  
Expansion Device Capillary\_Tube/Expansion\_Valve  
Cooling Fan  
Main Winding (Ohm) 12.85  
Start Winding (Ohm) 27.56

Current  
RLA (A) 1.65  
LRA (A) 10.5

Electrical Equipment CSIR

Overload T89009  
Time Check 6.5s - 16s / 7.00 A  
Open Temp 135° C  
Close Temp 52° C

Start Capacitor 64 µF / 250 V

Current Relay RP36\*\*  
Pick Up 4.35A  
Drop Out 3.7A

Refrigerating connection for OD  
Suction Tube 6.35 (1/4")  
Discharge Tube 4.76 (3/16")  
Process Tube 6.35 (1/4")

Certificates :



Note : Tecumseh reserves the right to change information contained in this document without notification.

<b>AE4425Y-FZ1A</b>	<b>Tension FZ : 220 - 240V 1~ 50 Hz</b>
---------------------	---

Les performances sont données dans les <b>conditions EN12900</b> :	Gaz aspirés : 20.0 °C
Condition Dew	Sous refroidissement : 0.0 K
The performance data are in <b>EN12900 conditions</b> :	Return gas : 20.0 °C
Dew Condition	Subcooling : 0.0 K

50 Hz R134a											
N°3025											
4   T condensation	5   T évaporation	(°C)	-25	-20	-15	-10	-5	0	5	10	15
<b>30</b>	1   P frigorifique	(Watt)	136	200	275	365	470	593	735	899	1087
	2   P absorbée	(W)	135	149	161	172	182	191	199	207	214
	3   I absorbée	(A)	1.21	1.24	1.27	1.29	1.32	1.34	1.36	1.38	1.40
<b>40</b>	1   P frigorifique	(Watt)	104	165	236	317	411	520	645	790	955
	2   P absorbée	(W)	135	153	171	186	201	214	227	238	250
	3   I absorbée	(A)	1.18	1.23	1.28	1.33	1.38	1.42	1.47	1.51	1.55
<b>50</b>	1   P frigorifique	(Watt)		128	193	265	348	443	552	676	819
	2   P absorbée	(W)		153	176	197	217	236	254	271	288
	3   I absorbée	(A)		1.22	1.29	1.36	1.43	1.50	1.57	1.63	1.70
<b>60</b>	1   P frigorifique	(Watt)			148	213	284	365	456	561	680
	2   P absorbée	(W)			179	207	233	258	283	306	329
	3   I absorbée	(A)			1.29	1.39	1.48	1.58	1.67	1.75	1.84

--	--	--	--	--	--	--	--	--	--	--	--

1 = cooling capacity 2 = power input 3 = current 4 = condensing temperature 5 = evaporating temperature
---

<p><b>Nota : Tecumseh se réserve le droit de modifier les informations contenues dans ce document sans préavis.</b></p> <p><b>Note : Tecumseh reserves the right to change information contained in this document without notification.</b></p>
---