



Compressor
Voltage Code : FZ

AE4425Z-FZ1A

High Temp. Commercial (HP)

220 - 240V 1~ 50 Hz

R404A

AE4425Z-FZ1A_BF

Operating conditions : **Customized... / 50 Hz / Dew**

Sound Power
ISO3745 / ISO 3743-1

Evaporating Temp. : -10.0 °C
Superheat : 10.0 K
Return gas temp. : 10.0 °C
Condensing Temp. : 45.0 °C
Subcooling : 10.0 K
Liquid : 34.7 °C

Refrig. Capacity : 328 Watt

Power Input : 221 Watt
Amps : 1.59 A
C.O.P : 1.48 Watt/W

56 dBA

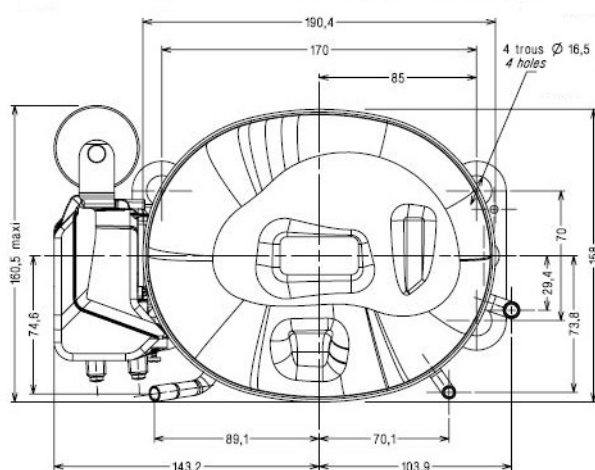
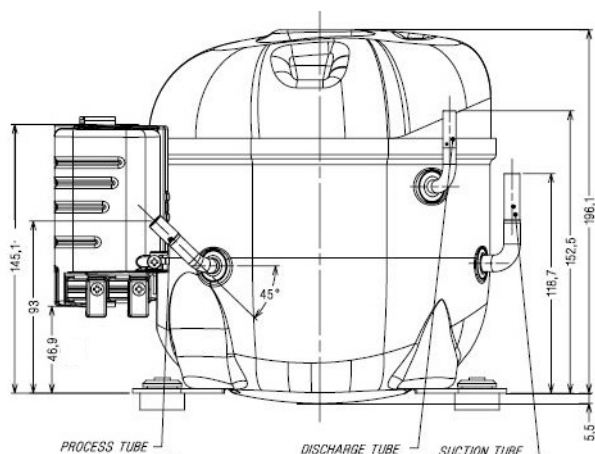

Displacement (cc) 4.2
Net Weight (Kg) 10.0
Oil Quantity (cc) 285.0
Oil Type Polyolester
Expansion Device Capillary_Tube/Expansion_Valve
Cooling Fan
Main Winding (Ohm) 10.3
Start Winding (Ohm) 30.0

Current
RLA (A) 1.8
LRA (A) 11

Electrical Equipment CSIR

Overload MRA58196
Time Check 6.5s - 16s / 7.4 A
Open Temp 120 °C
Close Temp 52°C

Start Capacitor 64 µF / 250 V

Current Relay RP42**
Pick Up 5.8A
Drop Out 4.95A

Refrigerating connection for OD
Suction Tube 6.35 (1/4")
Discharge Tube 4.76 (3/16")
Process Tube 6.35 (1/4")

Certificates :



Note : Tecumseh reserves the right to change information contained in this document without notification.

AE4425Z-FZ1A	Tension FZ : 220 - 240V 1~ 50 Hz
---------------------	---

Les performances sont données dans les conditions EN12900 :	Gaz aspirés : 20.0 °C
Condition Dew	Sous refroidissement : 0.0 K
The performance data are in EN12900 conditions :	Return gas : 20.0 °C
Dew Condition	Subcooling : 0.0 K

50 Hz R404A											
N°3033											
4 T condensation	5 T évaporation	(°C)	-25	-20	-15	-10	-5	0	5	10	15
30	1 P frigorifique	(Watt)	208	270	345	436	543	670	817	987	1181
	2 P absorbée	(W)	160	174	186	196	203	207	208	205	198
	3 I absorbée	(A)	1.45	1.48	1.50	1.53	1.54	1.55	1.56	1.56	1.55
40	1 P frigorifique	(Watt)	168	222	286	362	452	558	681	823	987
	2 P absorbée	(W)	164	182	199	213	226	235	242	246	245
	3 I absorbée	(A)	1.43	1.48	1.53	1.56	1.60	1.63	1.65	1.67	1.68
50	1 P frigorifique	(Watt)		175	228	290	362	446	545	659	792
	2 P absorbée	(W)		189	210	229	247	262	274	284	291
	3 I absorbée	(A)		1.48	1.55	1.61	1.66	1.71	1.75	1.79	1.82
60	1 P frigorifique	(Watt)			171	218	272	335	409	496	597
	2 P absorbée	(W)			220	244	267	288	306	322	335
	3 I absorbée	(A)			1.57	1.65	1.72	1.79	1.85	1.91	1.96

--	--	--	--	--	--	--	--	--	--	--	--

1 = cooling capacity 2 = power input 3 = current 4 = condensing temperature 5 = evaporating temperature

<p>Nota : Tecumseh se réserve le droit de modifier les informations contenues dans ce document sans préavis.</p> <p>Note : Tecumseh reserves the right to change information contained in this document without notification.</p>
