



Compressor
Voltage Code : FZ

AE4425U-FZ1A

High Temp. Commercial (HP)

220 - 240V 1~ 50 Hz

R290

AE4425U-FZ1A_BR

Operating conditions : **Customized... / 50 Hz / Dew**

Sound Power
ISO3745 / ISO 3743-1

Evaporating Temp. : -10.0 °C
Superheat : 10.0 K
Return gas temp. : 10.0 °C
Condensing Temp. : 45.0 °C
Subcooling : 10.0 K
Liquid : 34.7 °C

Refrig. Capacity : 348 Watt

Power Input : 205 Watt
Amps : 1.37 A
C.O.P : 1.70 Watt/W

56 dBA

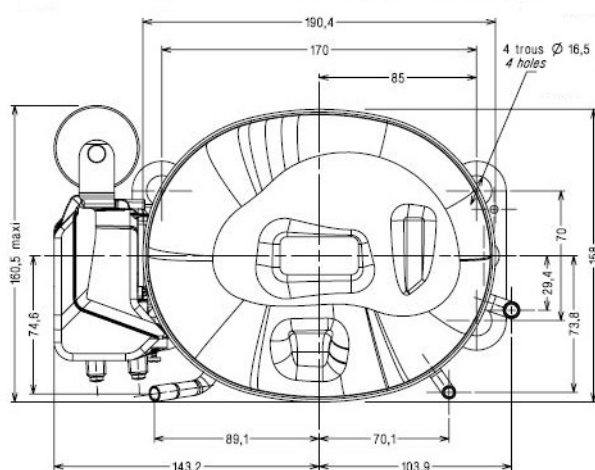
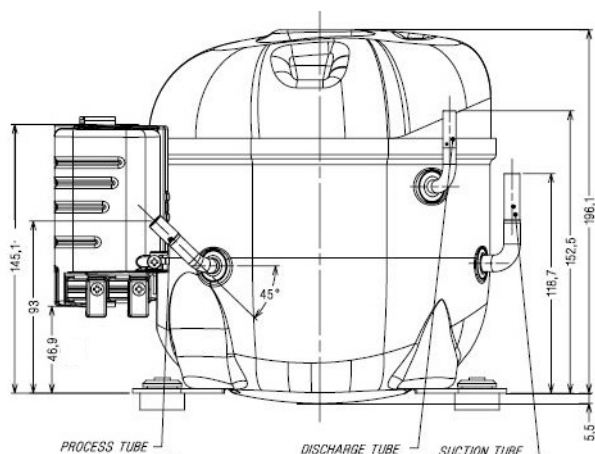

Displacement (cc) 5.02
Net Weight (Kg) 9.45
Oil Quantity (cc) 280.0
Oil Type Polyolester
Expansion Device Capillary_Tube or Expansion_Val
Cooling Fan
Main Winding (Ohm) 12.46
Start Winding (Ohm) 51.9

Current
RLA (A) 1.55
LRA (A) 9.5

Electrical Equipment CSIR

Overload MSP63AMZ
Time Check 6.5s - 15s / 7.40 A
Open Temp 120° C
Close Temp 61° C

Start Capacitor 64 µF / 250 V

Current Relay 9660D***-125
Pick Up 4.65A
Drop Out 3.95A

Refrigerating connection for OD
Suction Tube 6.35 (1/4")
Discharge Tube 4.76 (3/16")
Process Tube 6.35 (1/4")

Certificates :



Note : Tecumseh reserves the right to change information contained in this document without notification.

AE4425U-FZ1A	Tension FZ : 220 - 240V 1~ 50 Hz
---------------------	---

Les performances sont données dans les conditions EN12900 :	Gaz aspirés : 20.0 °C
Condition Dew	Sous refroidissement : 0.0 K
The performance data are in EN12900 conditions :	Return gas : 20.0 °C
Dew Condition	Subcooling : 0.0 K

50 Hz R290											
N°3023											
4 T condensation	5 T évaporation	(°C)	-25	-20	-15	-10	-5	0	5	10	15
30	1 P frigorifique	(Watt)	213	276	350	436	535	650	780	929	1096
	2 P absorbée	(W)	152	165	176	184	189	188	181	167	145
	3 I absorbée	(A)	1.22	1.26	1.29	1.31	1.32	1.31	1.29	1.27	1.23
40	1 P frigorifique	(Watt)		234	301	378	466	567	682	812	960
	2 P absorbée	(W)		170	185	198	208	215	217	214	203
	3 I absorbée	(A)		1.25	1.31	1.35	1.38	1.40	1.40	1.40	1.38
50	1 P frigorifique	(Watt)			250	318	395	483	582	695	823
	2 P absorbée	(W)			197	212	227	240	249	254	254
	3 I absorbée	(A)			1.33	1.39	1.44	1.49	1.52	1.54	1.54
60	1 P frigorifique	(Watt)				257	323	398	483	578	687
	2 P absorbée	(W)				233	250	266	281	292	300
	3 I absorbée	(A)				1.43	1.51	1.58	1.63	1.67	1.70

--	--	--	--	--	--	--	--	--	--	--	--

1 = cooling capacity 2 = power input 3 = current 4 = condensing temperature 5 = evaporating temperature

<p>Nota : Tecumseh se réserve le droit de modifier les informations contenues dans ce document sans préavis.</p> <p>Note : Tecumseh reserves the right to change information contained in this document without notification.</p>
