



Compressor
Voltage Code : FZ

AE4430U-FZ1A

High Temp. Commercial (HP)

220 - 240V 1~ 50 Hz

R290

AE4430U-FZ1A_BR

Operating conditions : **Customized... / 50 Hz / Dew**

Sound Power
ISO3745 / ISO 3743-1

Evaporating Temp. : -10.0 °C
Superheat : 10.0 K
Return gas temp. : 10.0 °C
Condensing Temp. : 45.0 °C
Subcooling : 10.0 K
Liquid : 34.7 °C

Refrig. Capacity : **417 Watt**

Power Input : 239 Watt
Amps : 1.61 A
C.O.P : 1.74 Watt/W

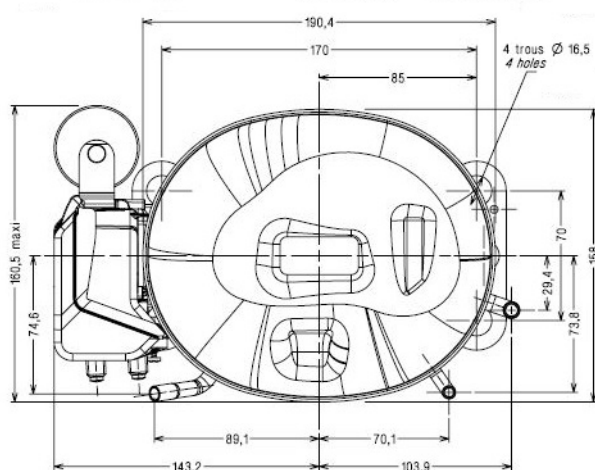
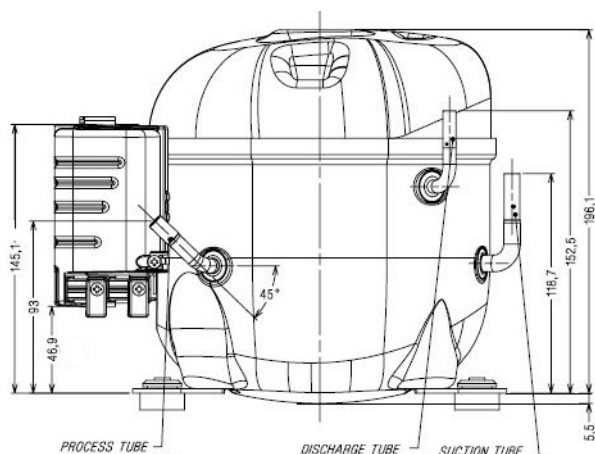

Displacement (cc) 6.12
Net Weight (Kg) 9.6
Oil Quantity (cc) 280.0
Oil Type Polyolester
Expansion Device Capillary_Tube/Expansion_Valve
Cooling Fan
Main Winding (Ohm) 10.09
Start Winding (Ohm) 33.84

Current
RLA (A) 1.88
LRA (A) 11.0

Electrical Equipment CSIR

Overload MSP61AMK
Time Check 6.5s - 16s / 7.80 A
Open Temp 105° C
Close Temp 61° C

Start Capacitor 64 µF / 250 V

Current Relay MTRP0046
Pick Up 4.65A
Drop Out 3.95A

Refrigerating connection for OD
Suction Tube 6.35 (1/4")
Discharge Tube 4.76 (3/16")
Process Tube 6.35 (1/4")

Certificates :



Note : Tecumseh reserves the right to change information contained in this document without notification.



Tecumseh

AE4430U-FZ1A	Tension FZ : 220 - 240V 1~ 50 Hz
---------------------	----------------------------------

Les performances sont données dans les **conditions EN12900** :
Condition Dew

Gaz aspirés : 20.0 °C
Sous refroidissement : 0.0 K

The performance data are in **EN12900 conditions** :
Dew Condition

Return gas : 20.0 °C
Subcooling : 0.0 K

50 Hz R290



N°3040

4 T condensation	5 T évaporation	(°C)	-25	-20	-15	-10	-5	0	5	10	15
30	1 P frigorigère	(Watt)	250	326	414	516	634	769	923	1098	1295
	2 P absorbée	(W)	167	184	196	205	209	209	204	197	185
	3 I absorbée	(A)	1.42	1.46	1.50	1.52	1.52	1.52	1.51	1.48	1.45
40	1 P frigorigère	(Watt)		279	360	452	557	677	813	967	1141
	2 P absorbée	(W)		194	214	229	240	246	249	247	242
	3 I absorbée	(A)		1.48	1.53	1.58	1.61	1.63	1.65	1.65	1.63
50	1 P frigorigère	(Watt)			301	382	473	577	695	828	979
	2 P absorbée	(W)			226	248	266	280	290	295	297
	3 I absorbée	(A)			1.56	1.63	1.69	1.74	1.78	1.80	1.81
60	1 P frigorigère	(Watt)				309	387	474	572	684	810
	2 P absorbée	(W)				264	290	311	328	340	349
	3 I absorbée	(A)				1.68	1.77	1.84	1.90	1.95	1.99

1 = cooling capacity 2 = power input 3 = current 4 = condensing temperature 5 = evaporating temperature

Nota : Tecumseh se réserve le droit de modifier les informations contenues dans ce document sans préavis.

Note : Tecumseh reserves the right to change information contained in this document without notification.