



Compressor
Voltage Code : TZ

TAJ4519T-TZ

High Temp. Commercial (HP)

400V 3~ 50Hz / 440V 3~ 60 Hz

R22

AJ4519T-TZ1C

Operating conditions : **Customized... / 50 Hz / Dew**

Sound Power
ISO3745 / ISO 3743-1

Evaporating Temp. : -10.0 °C
Superheat : 10.0 K
Return gas temp. : 10.0 °C
Condensing Temp. : 45.0 °C
Subcooling : 10.0 K
Liquid : 34.7 °C

Refrig. Capacity : **2820 Watt**

Power Input : 1388 Watt
Amps : 2.62 A
C.O.P : 2.03 Watt/W

70 dBA

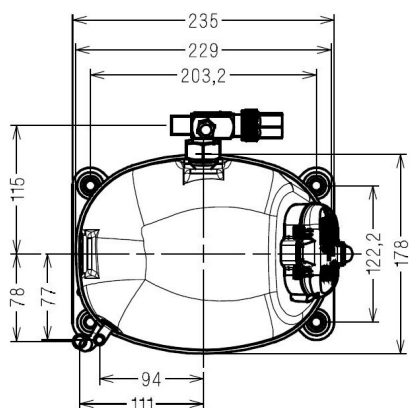
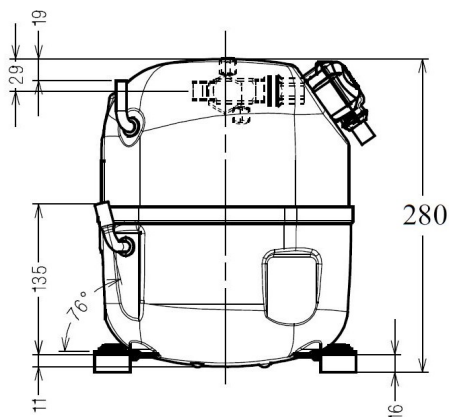

Displacement (cc) 34.5
Net Weight (Kg) 20.2
Oil Quantity (cc) 475.0
Oil Type Mineral
Expansion Device Capillary_Tube/Expansion_Valve
Cooling Fan
Main Winding (Ohm) 8.7

Current
RLA (A) 3.5 | 3.6
MCC (A) 4.2 | 4.2
LRA (A) 22 | 23

Electrical Equipment TRI

Overload Interne

Refrigerating connection for OD

Suction Tube 15.9 (5/8")
Discharge Tube 9.5 (3/8")
Process Tube 6.35 (1/4")

Certificates :



Note : Tecumseh reserves the right to change information contained in this document without notification.

TAJ4519T-TZ	Tension TZ : 400V 3~ 50Hz / 440V 3~ 60 Hz
--------------------	--

Les performances sont données dans les conditions EN12900 :	Gaz aspirés : 20.0 °C
Condition Dew	Sous refroidissement : 0.0 K
The performance data are in EN12900 conditions :	Return gas : 20.0 °C
Dew Condition	Subcooling : 0.0 K

50 Hz R22

N°234SU-TZ

4 T condensation	5 T évaporation	(°C)	-20	-15	-10	-5	0	5	10	15
40	1 P frigorifique	(Watt)	1971	2462	3039	3700	4441	5260	6155	7121
	2 P absorbée	(W)	1240	1303	1370	1440	1514	1590	1671	1754
	3 I absorbée	(A)	2.47	2.54	2.61	2.69	2.78	2.87	2.97	3.08
50	1 P frigorifique	(Watt)	1535	1975	2489	3076	3731	4453	5238	6083
	2 P absorbée	(W)	1174	1291	1407	1522	1635	1748	1858	1968
	3 I absorbée	(A)	2.34	2.48	2.63	2.78	2.94	3.10	3.26	3.43
60	1 P frigorifique	(Watt)		1462	1922	2443	3022	3655	4339	5071
	2 P absorbée	(W)		1278	1444	1604	1758	1906	2048	2184
	3 I absorbée	(A)		2.44	2.66	2.88	3.10	3.33	3.55	3.77

60 Hz R22

N°234SU-TZ

4 T condensation	5 T évaporation	(°C)	-20	-15	-10	-5	0	5	10	15
40	1 P frigorifique	(Watt)	2513	3024	3653	4398	5254	6218	7285	8453
	2 P absorbée	(W)	1369	1513	1653	1788	1919	2045	2165	2281
	3 I absorbée	(A)	2.29	2.48	2.66	2.83	3.00	3.17	3.33	3.48
50	1 P frigorifique	(Watt)	1961	2425	2991	3655	4414	5264	6200	7219
	2 P absorbée	(W)	1289	1499	1699	1890	2073	2245	2409	2563
	3 I absorbée	(A)	2.16	2.42	2.68	2.93	3.17	3.41	3.65	3.88
60	1 P frigorifique	(Watt)		1796	2309	2904	3575	4321	5135	6014
	2 P absorbée	(W)		1482	1744	1993	2227	2448	2655	2849
	3 I absorbée	(A)		2.37	2.70	3.03	3.35	3.66	3.97	4.28

1 = cooling capacity 2 = power input 3 = current 4 = condensing temperature 5 = evaporating temperature

Nota : Tecumseh se réserve le droit de modifier les informations contenues dans ce document sans préavis.

Note : Tecumseh reserves the right to change information contained in this document without notification.