

Model: B1.5-10.1Y

Refrigerant: R404A

Power supply: 400/3/50 DOL-STAR

Technical data:

Displacement	9.88 m³/h
Nominal compressor speed	1450 rpm
Motor voltage	400 V
Nominal operating frequency	50 Hz
maximum allowed operating current (MRA)	5.5 A
locked rotor current (LRA)	26.8 A
Number of pistons	2
Net weight	38 kg
Lubricant	FRASCOLD POE32
Oil charge	1 l

Motor connections:

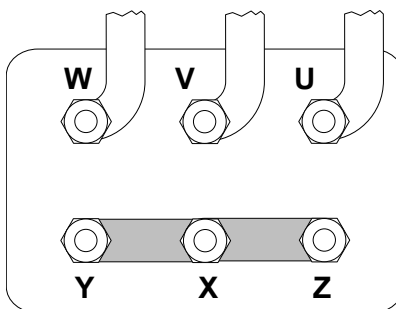

Application range:

Additional cooling required

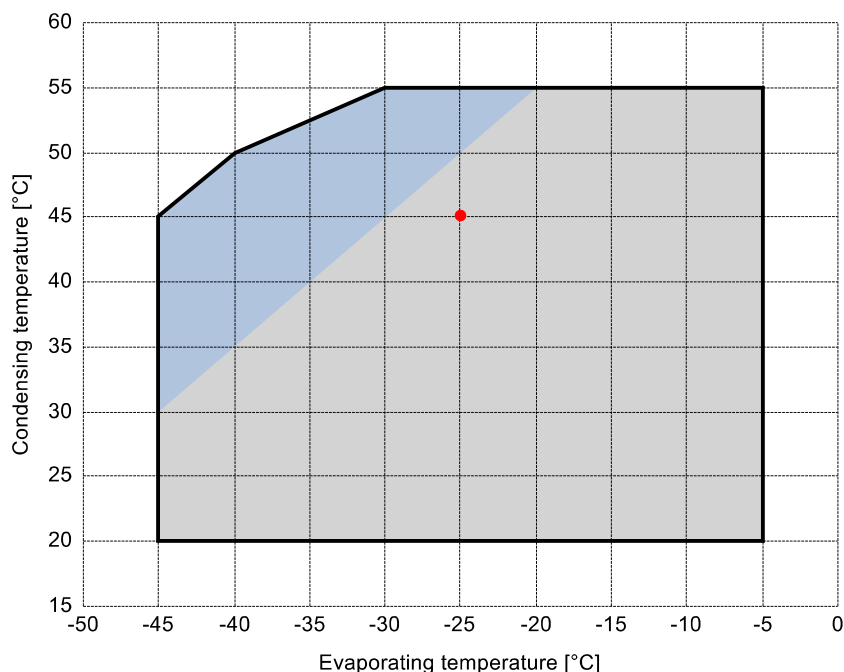

Reference conditions according to EN12900

- Suction gas temperature = 20 °C
- Liquid subcooling = 0 K
- 100% of the capacity

Certified by:

- ASERCOM (ref. EN12900, 50 Hz, 100% cap.)

All data subject to change without notice

Model: B1.5-10.1Y

Refrigerant: R404A

Power supply: 400/3/50 DOL-STAR

Dimensions:

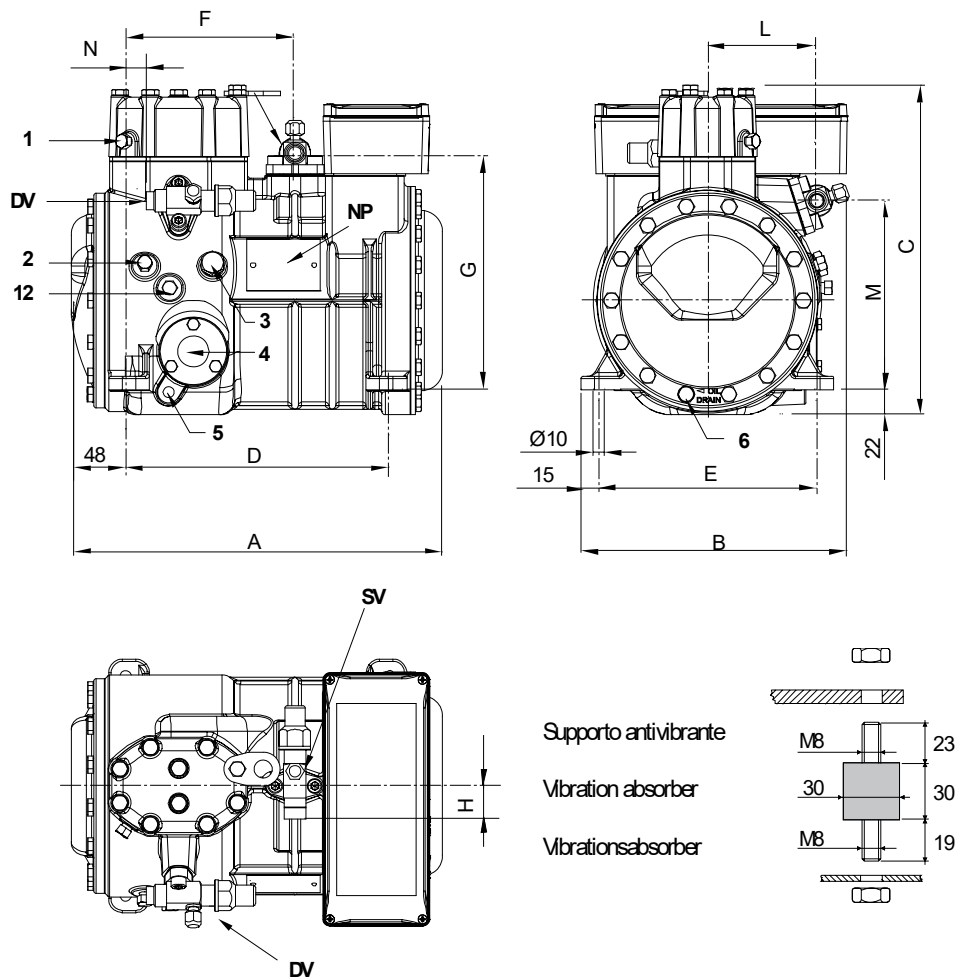

Legend:

SV: Suction Valve	5/8" in - 16 mm	M: Discharge valve	167 mm
DV: Discharge valve	1/2" in - 12.7 mm	N: Discharge valve	18 mm
A: Length	329 mm	1: High pressure connection	1/8" NPT
B: Width	237 mm	2: Low pressure connection	1/8" NPT
C: Height	292 mm	3: Oil charge plug	1/4" GAS
D: Base mounting	234 mm	4: Oil level sight glass	-
E: Base mounting	194 mm	5: Crankcase heater seat	-
F: Suction Valve	150 mm	6: Oil drain plug	M8 x 22
G: Suction Valve	209 mm	12: Oil return plug	1/8" NPT
H: Suction Valve	29 mm	NP: Nameplate	
I: Discharge valve	97 mm		

All data subject to change without notice

Model: B1.5-10.1Y

Refrigerant: R404A

Power supply: 400/3/50 DOL-STAR

P&I Diagram:

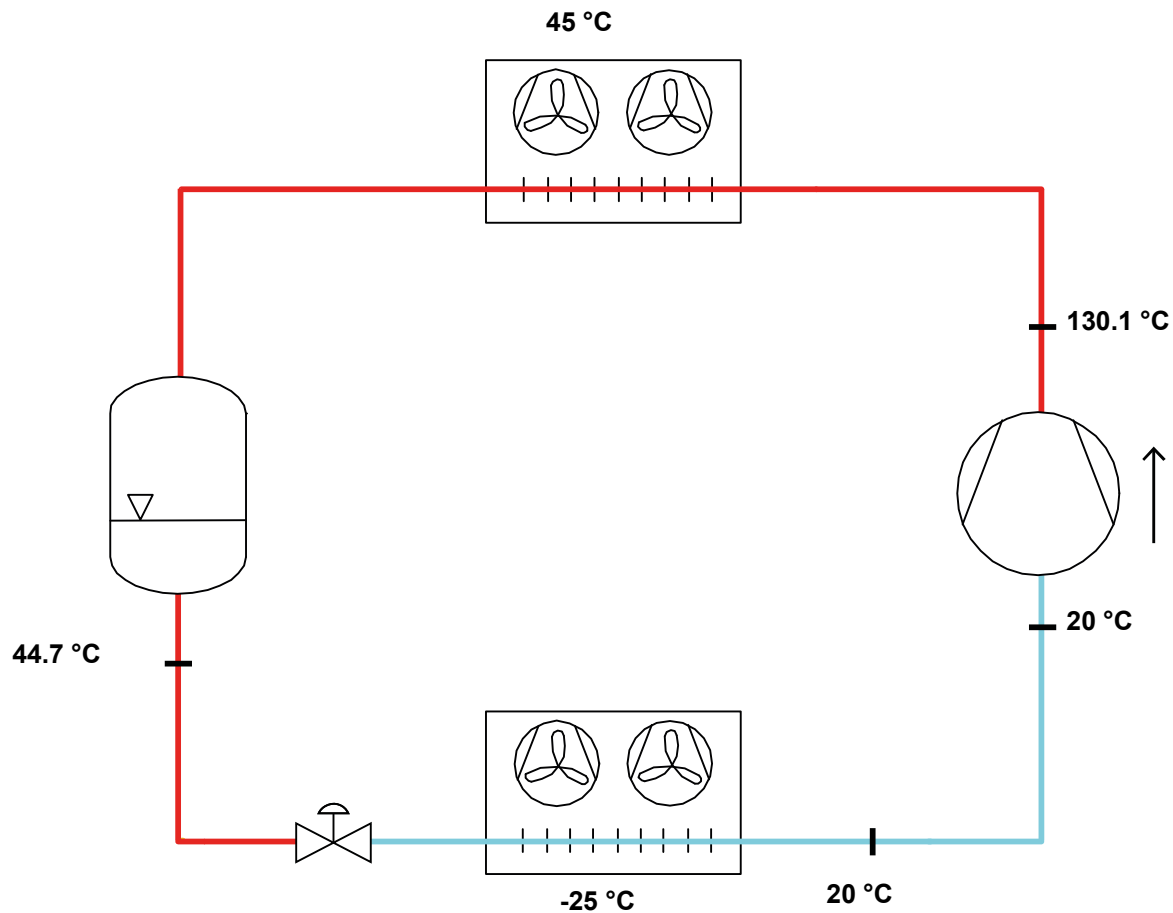

Model: B1.5-10.1Y

Refrigerant: R404A

Power supply: 400/3/50 DOL-STAR

Performance data:

Operating mode	Subcritical, 100 % of the capacity
Liquid subcooling	0 K
Suction gas temperature	20 °C
Useful fraction of superheating	100 %
Frequency	50 Hz
Additional cooling required	

Refrigerating capacity [kW]

T.Evap	-45 °C	-40 °C	-35 °C	-30 °C	-25 °C	-20 °C	-15 °C	-10 °C	-5 °C
T.Cond									
55 °C	-	-	-	1.396	1.843	2.367	2.98	3.694	4.52
50 °C	-	0.779	1.142	1.567	2.068	2.654	3.338	4.132	5.048
45 °C	0.544	0.883	1.281	1.751	2.304	2.953	3.709	4.584	5.589
40 °C	0.633	0.997	1.431	1.946	2.553	3.265	4.093	5.049	6.145
35 °C	0.732	1.123	1.593	2.153	2.814	3.59	4.49	5.528	6.715
30 °C	0.842	1.261	1.767	2.373	3.089	3.928	4.902	6.022	7.3
25 °C	0.964	1.41	1.954	2.605	3.377	4.281	5.328	6.53	7.9
20 °C	1.098	1.573	2.153	2.852	3.679	4.647	5.769	7.054	8.516

Power input [W]

T.Evap	-45 °C	-40 °C	-35 °C	-30 °C	-25 °C	-20 °C	-15 °C	-10 °C	-5 °C
T.Cond									
55 °C	-	-	-	1590	1847	2114	2382	2642	2885
50 °C	-	1107	1317	1550	1797	2050	2298	2533	2747
45 °C	901	1083	1291	1518	1754	1989	2216	2425	2607
40 °C	885	1068	1273	1491	1713	1931	2134	2314	2463
35 °C	878	1061	1260	1468	1674	1871	2049	2198	2311
30 °C	877	1057	1249	1444	1633	1807	1957	2074	2150
25 °C	881	1056	1238	1419	1588	1737	1858	1940	1976
20 °C	885	1054	1225	1388	1536	1658	1747	1793	1786

COP/EER [W/W]

T.Evap	-45 °C	-40 °C	-35 °C	-30 °C	-25 °C	-20 °C	-15 °C	-10 °C	-5 °C
T.Cond									
55 °C	-	-	-	0.88	1	1.12	1.25	1.4	1.57
50 °C	-	0.7	0.87	1.01	1.15	1.29	1.45	1.63	1.84
45 °C	0.6	0.82	0.99	1.15	1.31	1.48	1.67	1.89	2.14
40 °C	0.71	0.93	1.12	1.3	1.49	1.69	1.92	2.18	2.49
35 °C	0.83	1.06	1.26	1.47	1.68	1.92	2.19	2.51	2.91
30 °C	0.96	1.19	1.41	1.64	1.89	2.17	2.5	2.9	3.4
25 °C	1.09	1.34	1.58	1.84	2.13	2.46	2.87	3.37	4
20 °C	1.24	1.49	1.76	2.05	2.4	2.8	3.3	3.93	4.77

Current [A]

T.Evap	-45 °C	-40 °C	-35 °C	-30 °C	-25 °C	-20 °C	-15 °C	-10 °C	-5 °C
T.Cond									
55 °C	-	-	-	3.74	4.01	4.3	4.6	4.88	5.16
50 °C	-	3.35	3.49	3.7	3.95	4.23	4.51	4.76	5
45 °C	3.25	3.34	3.47	3.67	3.91	4.17	4.42	4.65	4.84
40 °C	3.24	3.33	3.46	3.64	3.86	4.1	4.33	4.53	4.69
35 °C	3.24	3.32	3.45	3.62	3.82	4.03	4.23	4.4	4.52
30 °C	3.24	3.32	3.44	3.6	3.78	3.96	4.13	4.26	4.34
25 °C	3.24	3.32	3.43	3.58	3.73	3.89	4.02	4.11	4.15
20 °C	3.24	3.32	3.42	3.55	3.68	3.81	3.9	3.95	3.94

All data subject to change without notice

Model: B1.5-10.1Y

Refrigerant: R404A

Power supply: 400/3/50 DOL-STAR

Performance data:

Operating mode	Subcritical, 100 % of the capacity
Liquid subcooling	0 K
Suction gas temperature	20 °C
Useful fraction of superheating	100 %
Frequency	50 Hz
Additional cooling required	

Mass flow [kg/h]	T.Evap	-45 °C	-40 °C	-35 °C	-30 °C	-25 °C	-20 °C	-15 °C	-10 °C	-5 °C
T.Cond										
55 °C	-	-	-	48	63	82	104	131	162	
50 °C	-	24	36	49	65	84	107	134	166	
45 °C	16	25	37	51	67	87	110	137	170	
40 °C	17	27	39	53	70	90	114	141	174	
35 °C	19	29	41	55	72	93	117	145	179	
30 °C	20	30	43	57	75	96	121	150	183	
25 °C	22	32	45	60	78	100	125	154	188	
20 °C	24	34	47	63	81	103	129	159	193	